



ENAPART



93 S Railroad Avenue Unit C
Bergenfield NJ 07621 USA
www.enapart.com
sales@enapart.com



Via del Canneto 35,
Borgosatollo, Brescia - Italia
www.enapart.it
vendite@enapart.it



Barbaros Mah. Ihlamur Bul. Aĝaoĝlu
My Newwork No:3/15 Ataşehir / İstanbul
www.enapart.net
satis@enapart.net



PRIVADA 10 B SUR #3908 COL.
ANZUREZ, C.P. 72530, PUEBLA, PUE
www.enapart.com.mx
sales@enapart.com.mx



Friedrich-Ebert-Anlage 36, 60325
Frankfurt am Main, Germany
www.enapart.de
anfrage@enapart.de



4 boulevard Carnot, 95400
villiers-le-bel, Paris, France
www.enapart.fr
sales@enapart.fr



65049, ОДЕСА, ВУЛИЦЯ ІВАНА
ФРАНКА, БУДИНОК 55, ПОВЕРХ 3
www.enapart.com.ua
sales@enapart.com.ua



MUNICIPIUL BUCUREȘTI, SECTOR 3,
B-DUL BASARABIA, NR.250, CORP P+5
www.enapart.ro
sales@enapart.ro



〒584-0023 大阪府富田林市若松町
東2丁目2番16号
www.enapart.co.jp
sales@enapart.co.jp



PLAZA NUESTRA SEÑORA DE LAS
NIEVES 12 ,LOCAL ,50012,ZARAGOZA
www.enapart.es
ventas@enapart.es



Складова база „Онгъл“, Склад А2, п.к.
4006, гр. Пловдив, България
www.enapart.bg
sales@enapart.bg



3 Austin Mews, High Street, Hemel
Hempstead, HP1 3AF , United Kingdom
www.enapart.co.uk
sales@enapart.co.uk



SLS Linear Displacement Sensors



**Creative solutions
for position measurement and control**

Hybrid Track

The hybrid track comprises a high resistivity conductive plastic film bonded to a precision wire-wound element. The conductive plastic film is wiped by a precious metal contact. The technology provides infinite resolution and a very long life



SLS 095



SLS 095 is designed to provide maximum performance benefits within an extremely compact body diameter of 9.5mm, with stroke lengths from 10 to 100mm.

The miniature size of this sensor makes it ideal for applications in robotics, animatronics, medical equipment and motorsport data acquisition.

PERFORMANCE

	mm	10	20	30	40	50	75	100	
Electrical stroke E	mm	10	20	30	40	50	75	100	
Resistance ±10%	kΩ	0.4†	0.8	1.2	1.6	2.0	3.0	4.0	†±15% for SLS 095/10
Independent linearity	±%	0.5	0.35	0.25	0.25	0.25	0.15	0.15	
Power dissipation at 20°C	W	0.2	0.4	0.6	0.8	1.0	1.5	2.0	
Applied voltage maximum	Vdc	8.9	17.9	26	40	44	67	74	
Resolution		Virtually infinite							
Hysteresis (repeatability)		Less than 0.01mm							
Operational temperature	°C	-30 to +100							
Output smoothness		To MIL-R-39023 grade C 0.1%							
Insulation resistance		Greater than 100MΩ at 500V d.c.							
Operating mode		Voltage divider only - see Circuit Recommendations on page 2							
Wiper circuit impedance		Minimum of 100 x track resistance or 0.5MΩ (whichever is greater)							
Operating force maximum									
sealed	gf	300 in horizontal plane							
unsealed	gf	100 in horizontal plane							
Life at 250mm per second		Typically greater than 100 million operations (50 x 10 ⁶ cycles) at 25mm stroke length							
Dither life		200 million operations (100 x 10 ⁶ cycles) at ±0.5mm, 60Hz							
Shaft seal life		20 million operations (10 x 10 ⁶ cycles)							
Sealing		IP50 standard - IP66 see options							
Shaft velocity maximum	m/s	2.5							
Vibration		RTCA 160D 10Hz to 2kHz (random) @ 4.12g (rms) - all axes							
Shock		40g 6mS half sine							

OPTIONS

IP 66 sealing	Designed to accept integral shaft seal to give IP66 rating
Mounting	Can be supplied with self aligning bearings or a plain body for use with body clamps or flange mounting kit.

AVAILABILITY

All configurations can be supplied within five days from the factory

ORDERING CODES

SLS 095/...../...../...../.....

Electrical stroke	_____	_____	_____	_____	Sealing 50 = IP50, 66 = IP66
Resistance	_____	_____	_____	_____	Mounting option R = Self aligning bearing P = Plain

Accessories (order separately)

Mounting kits	_____	Body clamp kit - SA200841
		Flange kit - SA200842

DIMENSIONS AND MOUNTING OPTIONS

SELF ALIGNING BEARING MOUNTING

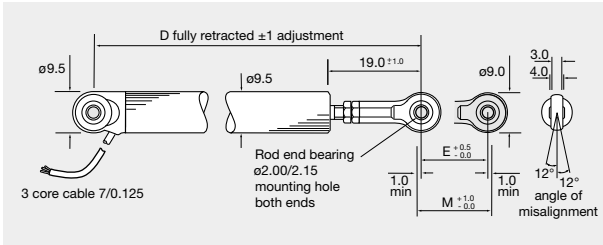

PLAIN BODY MOUNTING

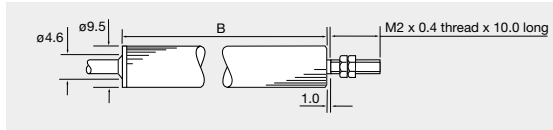

Note: Drawings not to scale

MOUNTING OPTIONS

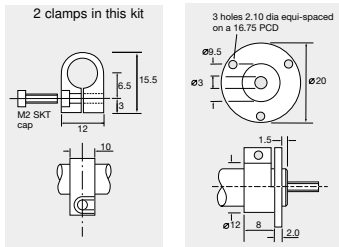

Body clamp
SA200841

Flange mounting
SA200842

Electrical stroke E	mm	10	20	30	40	50	75	100
Mechanical stroke M	mm	12.5	22.5	32.5	42.5	52.5	77.5	102.5
Body length B	mm	45.5	55.5	65.5	75.5	85.5	110.5	135.5
Between centres D		70	80	90	100	110	135	160
Weight approximate (Mounting option R)	g	11	13	14.5	16	17.5	21.5	25.5

ELECTRICAL CONNECTIONS

3 core cable: PUR sheathed 0.3m long with PTFE insulated 7/0.125 cores.

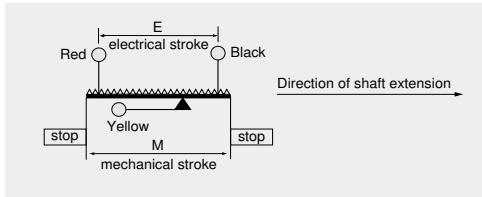

SLS 130



The SLS 130 range is designed to provide performance benefits within a compact, lightweight package in stroke lengths from 25 to 200mm.

With a choice of mounting options and accessories, this sensor is ideally suited to a wide range of industrial applications and is extensively used within the motorsport industry.

PERFORMANCE

	mm	25	50	75	100	125	150	175	200
Electrical stroke E	mm	25	50	75	100	125	150	175	200
Resistance ±10%	kΩ	1	2	3	4	5	6	7	8
Independent linearity									
guaranteed	±%	0.25	0.25	0.15	0.15	0.15	0.15	0.15	0.15
typical	±%	0.15	0.15	0.15	0.10	0.10	0.07	0.07	0.07
Power dissipation at 20°C	W	0.5	1.0	1.5	2.0	2.5	3.0	3.5	4.0
Applied voltage maximum	Vdc	22	44	67	74	74	74	74	74
Electrical output		Minimum of 0.5% to 99.5% applied volts							
Resolution		Virtually infinite							
Hysteresis (repeatability)		Less than 0.01mm							
Operational temperature	°C	-30 to +100							
Output smoothness		To MIL-R-39023 grade C 0.1%							
Insulation resistance		Greater than 100MΩ at 500V d.c.							
Operating mode		Voltage divider only - see Circuit Recommendations on page 2							
Wiper circuit impedance		Minimum of 100 x track resistance or 0.5MΩ (whichever is greater)							
Operating force maximum									
sealed	gf	500 in horizontal plane							
unsealed	gf	250 in horizontal plane							
Life at 250mm per second		Typically greater than 100 million operations (50 x 10 ⁶ cycles) at 25mm stroke length							
Dither life		200 million operations (100 x 10 ⁶ cycles) at ±0.5mm, 60Hz							
Sealing		IP50 standard - IP66 see options							
Shaft seal life		20 million operations (10 x 10 ⁶ cycles) - replaceable							
Shaft velocity maximum	m/s	10							

OPTIONS

Compact shaft	Compact shaft will reduce dimension D by 25mm
Integral shaft seal - IP 66	Designed to accept integral shaft seal to give IP66 rating
Extended cable length	10m output cable can be specified
Mounting	Body clamp, flange or quick release balljoint mounting kits can be supplied
Protective sleeve kit	For all stroke lengths - self aligning bearings only
Spring loaded shaft kit	For stroke lengths 25 to 150mm only

AVAILABILITY

All options can be supplied within five days from the factory.

ORDERING CODES

SLS 130/...../...../...../...../.....

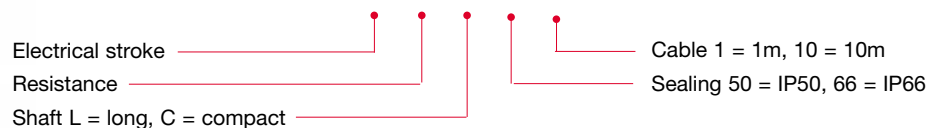

Accessories (order separately)

Mounting kits	Body clamp kit - SA200264
	Flange kit - SA200266
	Quick release balljoint (Heim) - SA200337

Protective sleeve kit -	SA201152/MK [†]
Spring loaded shaft kit -	SA200265/stroke
	(For use with option L/50 units only)

[†] Check with Penny & Giles for correct part number to match stroke and shaft combination

DIMENSIONS AND MOUNTING OPTIONS

SELF ALIGNING BEARING MOUNTING

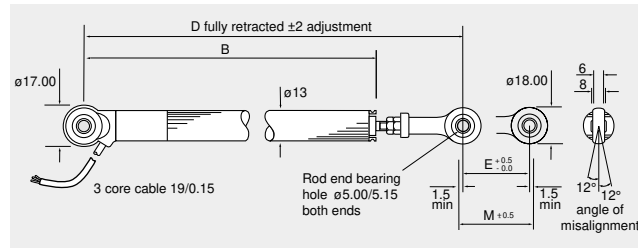

PROTECTIVE SLEEVE OPTION - SA201152/MK

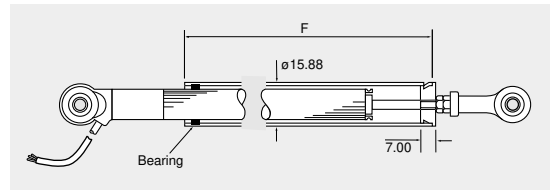

Note: Drawings not to scale

SPRING RETURN OPTION

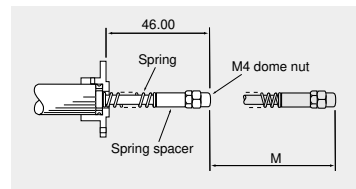

SA200265/stroke
(25 to 150mm stroke lengths only)

MOUNTING OPTIONS

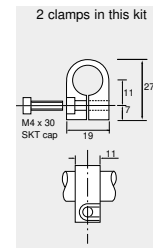

Body clamp
SA200264

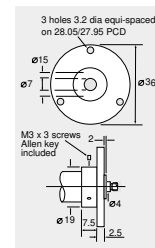

Flange mounting
SA200266

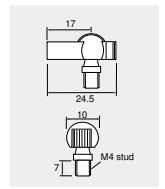

Quick release
ball joint
SA200337

Electrical stroke E	mm	25	50	75	100	125	150	175	200
Mechanical stroke M	mm	29	54	79	104	129	154	179	204
Body length B	mm	110.5	135.5	160.5	185.5	210.5	235.5	260.5	285.5
Between centres D									
standard sensor (L)	mm	173.6	198.6	223.6	248.6	273.6	298.6	323.6	348.6
compact shaft sensor (C)	mm	148.6	173.6	198.6	223.6	248.6	273.6	298.6	323.6
Sleeve length F									
standard sensor (L)	mm	98	123	148	173	198	223	248	273
compact shaft sensor (C)	mm	73	98	123	148	173	198	223	248
Weight approximate									
standard sensor (L)	g	64	71	78	85	92	99	106	113
compact shaft sensor (C)	g	60	67	74	81	88	95	102	109

ELECTRICAL CONNECTIONS

3 core cable: PUR sheathed 1m long with ETFE insulated 19/0.15 cores.

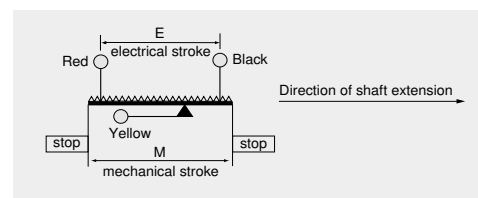

SLS 190



The SLS 190 range is designed to provide maximum performance benefits within a compact package in stroke lengths from 25 to 350mm.

With a choice of mounting options and accessories, this sensor is ideally suited to a wide range of general purpose industrial applications, for medium stroke linear position sensing.

PERFORMANCE

	mm	25	50	75	100	125	150	175	200	225	250	275	300	325	350
Electrical stroke E	mm	25	50	75	100	125	150	175	200	225	250	275	300	325	350
Resistance $\pm 10\%$	k Ω	1	2	3	4	5	6	7	8	9	10	11	12	13	14
Independent linearity															
guaranteed	$\pm\%$	0.25	0.25	0.15	0.15	0.15	0.15	0.15	0.15	0.15	0.15	0.15	0.15	0.15	0.15
typical	$\pm\%$	0.15	0.15	0.15	0.10	0.10	0.07	0.07	0.07	0.07	0.05	0.05	0.05	0.05	0.05
Power dissipation at 20°C	W	0.5	1.0	1.5	2.0	2.5	3.0	3.5	4.0	4.5	5.0	5.5	6.0	6.5	7.0
Applied voltage maximum	Vdc	22	44	67	74	74	74	74	74	74	74	74	74	74	74
Electrical output		Minimum of 0.5% to 99.5% applied volts													
Resolution		Virtually infinite													
Hysteresis (repeatability)		Less than 0.01mm													
Operational temperature	°C	-30 to +100													
Output smoothness		To MIL-R-39023 grade C 0.1%													
Insulation resistance		Greater than 100M Ω at 500V d.c.													
Operating mode		Voltage divider only - see Circuit Recommendations on page 2													
Wiper circuit impedance		Minimum of 100 x track resistance or 0.5M Ω (whichever is greater)													
Operating force maximum															
sealed	gf	500 in horizontal plane													
unsealed	gf	250 in horizontal plane													
Life at 250mm per second		Typically greater than 100 million operations (50 x 10 ⁶ cycles) at 25mm stroke length													
Dither life		200 million operations (100 x 10 ⁶ cycles) at ± 0.5 mm, 60Hz													
Sealing		IP50 standard - IP66 see options													
Shaft seal life		20 million operations (10 x 10 ⁶ cycles) - replaceable													
Shaft velocity maximum	m/s	10													

OPTIONS

Compact shaft	Compact shaft will reduce dimension D by 25mm
Integral shaft seal - IP 66	Designed to accept integral shaft seal to give IP66 rating
Extended cable length	10m output cable can be specified
Mounting	Body clamp or flange mounting kits can be supplied
Protective sleeve kit	For all stroke lengths - self aligning bearings only

AVAILABILITY

All options can be supplied within five days from the factory.

ORDERING CODES

SLS 190/...../...../...../...../.....

Electrical stroke	_____	Cable 1 = 1m, 10 = 10m
Resistance	_____	Sealing 50 = IP50, 66 = IP66
Shaft L = long, C = compact	_____	

Accessories (order separately)

Mounting kits	_____	Body clamp kit - SA59019
	_____	Flange kit - SA59020

Protective sleeve kit - SA201148/MK[†]

[†] Check with Penny & Giles for correct part number to match stroke and shaft combination

DIMENSIONS AND MOUNTING OPTIONS

SELF ALIGNING BEARING MOUNTING

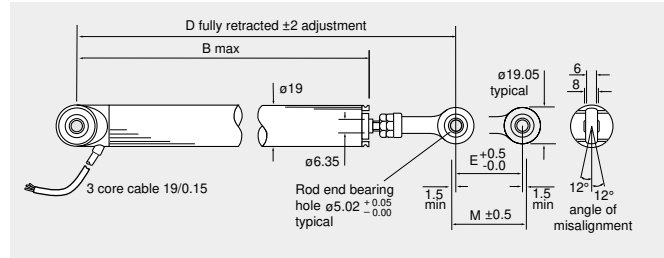

PROTECTIVE SLEEVE OPTION - SA201148/MK

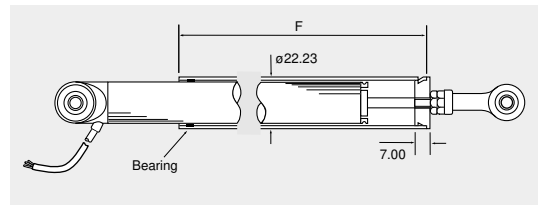

Note: Drawings not to scale

MOUNTING OPTIONS

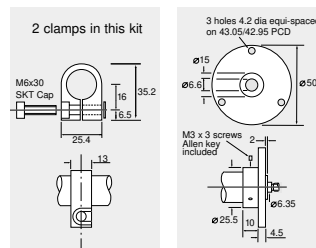

**Body clamp
SA59019**

**Flange mounting
SA59020**

		25	50	75	100	125	150	175	200	225	250	275	300	325	350
Electrical stroke E	mm	25	50	75	100	125	150	175	200	225	250	275	300	325	350
Mechanical stroke M	mm	29	54	79	104	129	154	179	204	229	254	279	304	329	354
Body length B	mm	110.5	135.5	160.5	210.5	235.5	260.5	285.5	310.5	333.5	360.5	385.5	435.5	460.5	485.5
Between centres D															
standard sensor (L)	mm	173.6	198.6	223.6	273.6	298.6	323.6	348.6	373.6	398.6	423.6	448.6	498.6	523.6	548.6
compact shaft sensor (C)	mm	148.6	173.6	198.6	248.6	273.6	298.6	323.6	348.6	373.6	398.6	423.6	473.6	498.6	523.6
Sleeve length F															
standard sensor (L)	mm	98	123	148	198	223	248	273	296	323	348	373	423	448	473
compact shaft sensor (C)	mm	73	98	123	173	198	223	248	273	296	323	348	398	423	448
Weight approximate															
standard sensor (L)	g	109	126	144	161	179	196	214	231	249	266	284	301	319	336
compact shaft sensor (C)	g	103	120	138	155	173	190	208	225	246	260	278	295	316	330

ELECTRICAL CONNECTIONS

3 core cable: PUR sheathed 1m long with ETFE insulated 19/0.15 cores.

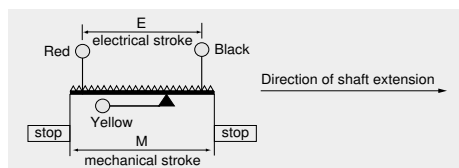

SLS 220



SLS 220 linear displacement sensors have a 10mm or 20mm stroke range with a spring loaded operation and a mounting flange to allow easy installation. Contained within a high strength Nylatron® housing, this provides good chemical resistance and low weight. The internal potentiometer assembly is protected to IP66. Suited to OEM and process monitoring applications, this new sensor replaces Penny+Giles HLP 220 model.

PERFORMANCE

Electrical stroke E	mm	10	20
Resistance	kΩ	0.4 ±15%	0.8 ±10%
Independent linearity	±%	0.5	0.35
Power dissipation at 20°C	W	0.2	0.4
Applied voltage maximum	Vdc	8.9	17.9
Resolution		Virtually infinite	
Hysteresis (repeatability)		Less than 0.01mm	
Operational temperature	°C	-30 to +100	
Output smoothness		To MIL-R-39023 grade C 0.1%	
Insulation resistance		Greater than 100MΩ at 500V d.c.	
Operating mode		Voltage divider only - see Circuit Recommendations on page 2	
Wiper circuit impedance		Minimum of 100 x track resistance or 0.5MΩ (whichever is greater)	
Operating force maximum	kgf	4.0	
Life at 250mm per second		Typically greater than 20 million operations (10 x 10 ⁶ cycles)	
Sealing		Internally sealed to IP66 (spring loaded plunger is unsealed, so care must be taken when selecting for environments which have a risk of particle contamination)	
Shaft velocity maximum	m/s	2.5	

AVAILABILITY & ORDERING CODES

Supplied from stock or within five days from the factory

SLS 220/...../.....

Electrical stroke Resistance

DIMENSIONS

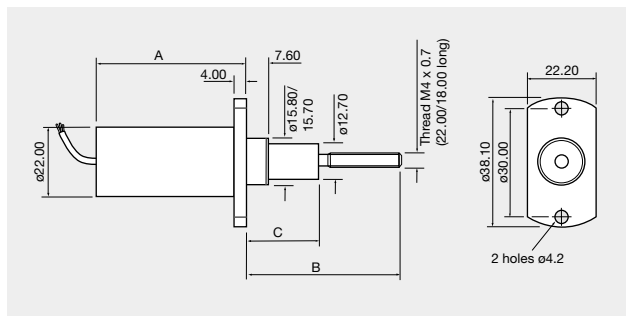

Note: Drawings not to scale

Electrical stroke E	mm	10	20
Mechanical stroke M	mm	12.5	22.5
Body length A	mm	44.4	54.4
Shaft extended - B	mm	43	53
Shaft extended - C	mm	20	30
Weight approximate	g	45	50

Note: Nominal shaft position is fully extended (spring loaded)

MATERIALS

Body	Nylatron® MC901 (blue)
Shaft	Stainless steel

ELECTRICAL CONNECTIONS

3 core cable: PUR sheathed 0.3m long with PTFE insulated 7/0.125 cores.

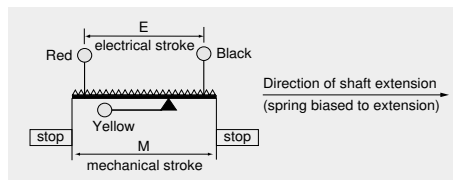

SLS 320



The SLS 320 range is designed to provide maximum performance benefits within a body diameter of 32mm, with stroke lengths from 250 to 1600mm.

With a choice of mounting options and accessories, this sensor is ideally suited to a wide range of heavier duty industrial applications, for medium to long stroke linear position sensing.

PERFORMANCE

Electrical stroke E	mm	250	300	350	400	450	500	550	600	650	700	750	800	850	900
Resistance $\pm 10\%$	k Ω	10	12	14	16	18	20	22	24	26	28	30	32	34	36
Power dissipation at 20°C	W	5.0	6.0	7.0	8.0	9.0	10	11	12	13	14	15	16	17	18
Electrical stroke E	mm	950	1000	1050	1100	1150	1200	1250	1300	1350	1400	1450	1500	1550	1600
Resistance $\pm 10\%$	k Ω	38	40	42	44	46	48	50	52	54	56	58	60	62	64
Power dissipation at 20°C	W	19	20	21	22	23	24	25	26	27	28	29	30	31	32
Independent linearity															
guaranteed	$\pm\%$	0.15													
typical	$\pm\%$	0.05													
Applied voltage - maximum	Vdc	74													
Electrical output		Minimum of 0.5% to 99.5% applied volts													
Resolution		Virtually infinite													
Hysteresis (repeatability)	mm	Less than 0.01													
Operational temperature	°C	-30 to +100													
Output smoothness		To MIL-R-39023 grade C 0.1%													
Insulation resistance		Greater than 100M Ω at 500V d.c.													
Operating mode		Voltage divider only - see Circuit Recommendations on page 2													
Wiper circuit impedance		Minimum of 100 x track resistance or 0.5M Ω (whichever is greater)													
Operating force - maximum															
sealed	gf	2000 in horizontal plane (break-out force 5000gf)													
unsealed	gf	1500 in horizontal plane (break-out force 2000gf)													
Life at 250mm per second		Typically in excess of 100 million operations (50 x 10 ⁶ cycles) at 25mm stroke length													
Dither life		200 million operations (100 x 10 ⁶ cycles) at ± 0.5 mm, 60Hz													
Sealing		IP50 standard - IP66 see options													
Shaft seal life		20 million operations (10 x 10 ⁶ cycles) - replaceable													
Shaft velocity - maximum	m/s	10													

OPTIONS

Compact shaft	Compact shaft will reduce dimension D by 50mm
Integral shaft seal - IP 66	Designed to accept integral shaft seal to give IP66 rating
Cabled socket	1m or 10m cabled socket assemblies available
Mounting	Body clamp or flange mounting kits can be supplied
Protective sleeve kit	For all stroke lengths - self aligning bearings only

AVAILABILITY

Up to 1100mm stroke - All configurations can be supplied within five days from the factory
1150 to 1600mm stroke - All configurations can be supplied within ten days from the factory

ORDERING CODES

SLS 320/...../..... K/...../...../.....

Electrical stroke	_____	_____	_____	_____	_____	Cabled socket	00 = None
Resistance	_____	_____	_____	_____	_____		01 = 1m
Shaft L = long, C = compact	_____	_____	_____	_____	_____		10 = 10m
							Sealing 50 = IP50, 66 = IP66

Accessories (order separately)

Mounting kits	<ul style="list-style-type: none"> Body clamp kit - SA59661 Flange kit - SA59660
Protective sleeve kit -	SA200991/MK [†]

[†] Check with Penny & Glies for correct part number to match stroke and shaft combination

DIMENSIONS AND MOUNTING OPTIONS

Mounting recommendations:
For units 1150 to 1600mm stroke, we recommend the use of body clamp or flange mounting kits to support the sensor when horizontally mounted. Alternatively, use the protective sleeve kit with the self aligning bearing mountings to provide increased rigidity.

SELF ALIGNING BEARING MOUNTING

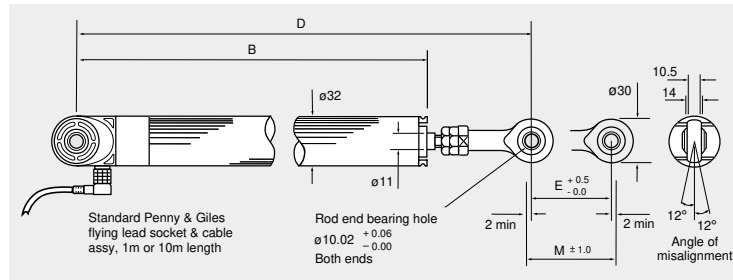

Note: Drawings not to scale

PROTECTIVE SLEEVE OPTION - SA200991/MK

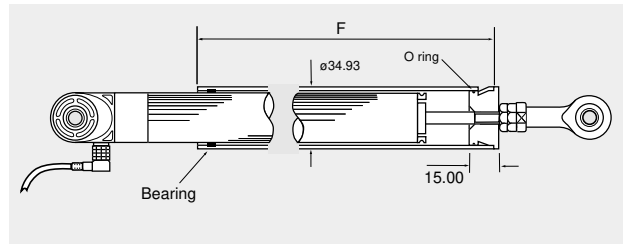

MOUNTING OPTIONS

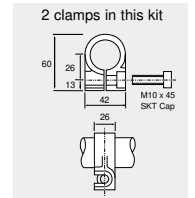

Body clamp SA59661

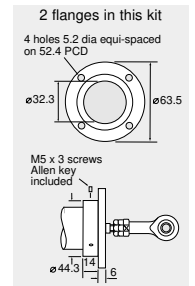

SA59660 Flange mounting

Electrical stroke E	mm	250	300	350	400	450	500	550	600	650	700	750	800	850	900
Mechanical stroke M	mm	255	305	355	405	455	505	555	605	655	705	755	805	855	905
Body length B	mm	366	416	466	516	601	651	701	751	801	851	901	986	1036	1086
Between centres D															
standard sensor (L)	mm	480	530	580	630	710	760	810	860	910	960	1010	1095	1145	1195
compact shaft sensor (C)	mm	430	480	530	580	660	710	760	810	860	910	960	1045	1095	1145
Sleeve length F															
standard sensor (L)	mm	370	420	470	520	605	655	705	755	805	855	905	990	1040	1090
compact shaft sensor (C)	mm	320	370	420	470	555	605	655	705	755	805	855	940	990	1040
Weight approximate (no sleeve)															
standard sensor (L)	g	590	673	756	839	922	1005	1088	1171	1254	1337	1420	1503	1586	1669
compact shaft sensor (C)	g	555	638	721	804	887	970	1053	1136	1219	1302	1385	1468	1551	1634
Electrical stroke E	mm	950	1000	1050	1100	1150	1200	1250	1300	1350	1400	1450	1500	1550	1600
Mechanical stroke M	mm	955	1005	1055	1105	1155	1205	1255	1305	1355	1405	1455	1505	1555	1605
Body length B	mm	1136	1186	1236	1286	1371	1421	1471	1521	1571	1621	1671	1721	1771	1821
Between centres D															
standard sensor (L)	mm	1245	1295	1345	1395	1480	1530	1580	1630	1680	1730	1780	1830	1880	1930
compact shaft sensor (C)	mm	1195	1245	1295	1345	1430	1480	1530	1580	1630	1680	1730	1780	1830	1880
Sleeve length F															
standard sensor (L)	mm	1140	1190	1240	1290	1375	1425	1475	1525	1575	1625	1675	1725	1775	1825
compact shaft sensor (C)	mm	1090	1140	1190	1240	1325	1375	1425	1475	1525	1575	1625	1675	1725	1775
Weight approximate (no sleeve)															
standard sensor (L)	g	1752	1835	1918	2000	2095	2190	2285	2380	2475	2570	2665	2760	2855	2950
compact shaft sensor (C)	g	1717	1800	1883	1965	2060	2155	2250	2345	2440	2535	2630	2725	2820	2915

ELECTRICAL CONNECTIONS

Right angled, cabled socket

E series M12 to IEC 60947-5-2 PUR jacket.
Conforms to DIN/VDE 0660 part 208A2

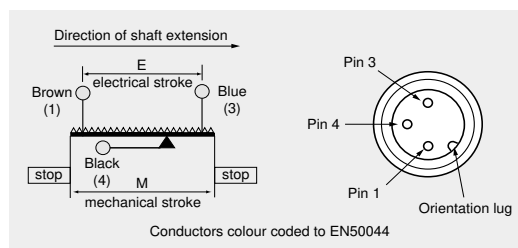

Cabled Socket

1 metre long No. x61-169-001
(Hirschmann No. 933 316-021/1m)
10 metres long No. x61-169-010
(Hirschmann No. 933 316-021/10m)

Specialised Designs

We have considerable experience in solving specific application problems by developing our standard designs to suit individual requirements. Custom-designed solutions are also provided where standard equipment does not fully meet our customer's needs.

ICS 100 In-Cylinder Sensors

Suitable for actuator strokes up to 1100mm

A range of In-Cylinder linear position sensors designed for integration into hydraulic and pneumatic actuators where the sensor is fitted inside the pressurised environment. Using the proven benefits of Hybrid Track Technology and including a number of unique design features, the ICS100 range is ideally suited to high volume OEM actuator manufacturers, where design engineers can specify an affordable alternative for applications where non-contacting technologies may prove too expensive.

Ask for our **ICS100 In-Cylinder Sensors** brochure for full details and designers guide. It can also be downloaded from our website at www.pennyandgiles.com



SLS 320 for heavy duty-cycle dynamic applications

A number of specialist applications have demanded an enhanced operating life beyond that capable of the standard SLS320 sealed linear sensor. To meet this requirement, we have developed an oil-filled version of the SLS320, which provides optimum lubrication for the track and sliding mechanism for increased operating life.

Typically the sensors are mounted parallel to actuators fitted to hydraulic motion bases operating leisure ride cabins at amusement parks around the world. Typically the motion bases run a three minute cycle time for up to 12 hours per day. This sensor is ideally suited to similar applications subjected to heavy duty dynamic movements.



SPECIFICATION SUMMARY

Refer to page 12 and 13 for full performance specification and dimensions

Electrical stroke E	mm	250 to 1100mm only
Sealing		IP66
Shaft seal life		20 million operations (10 x 10 ⁶) - replaceable
Shaft velocity - maximum	m/s	10

OPTIONS

Compact shaft	Compact shaft will reduce dimension D (page 13) by 50mm
Cabled socket	1m or 10m cabled socket assemblies available
Mounting	Self aligning rod ends standard. Body clamp and flange kits available
Protective sleeve	For 250 to 1100mm stroke lengths - self aligning bearings only.

AVAILABILITY

Can be supplied within five days from the factory

ORDERING CODES

D45566/...../..... K/...../ 66 /.....

Electrical stroke	_____	Cabled socket	00 = None
Resistance	_____		01 = 1m
Shaft L = long, C = compact	_____		10 = 10m

Accessories (order separately)

Mounting kits	Body clamp kit - SA59661
	Flange kit - SA59660

Protective sleeve kit - SA200991/MK

Clamp sleeve (to allow SLS 320 to replace Penny & Giles HLP 350 in existing installations) - P200863 (2 per sensor)

Special SLS 190

This specially developed SLS 190 variant offers the same mounting dimensions as earlier HLP190 models, but incorporates additional shaft sealing not previously available. M5 steel rod end bearings are fitted, which has become a standard requirement in US NASCAR data acquisition systems. An optional LEMO connector can also be supplied fitted to the cable if required. These potentiometers are ideally suited for retrofit in existing suspension and throttle position applications and will provide high performance and reliability under extreme operating conditions.

PERFORMANCE

Electrical stroke E	mm	25	50	75	100	125	150	200	250
Resistance $\pm 10\%$	k Ω	1	2	3	4	5	6	8	10
Independent linearity	$\pm\%$	0.25	0.25	0.15	0.15	0.15	0.15	0.15	0.15
Power dissipation at 20°C	W	0.5	1.0	1.5	2.0	2.5	3.0	4.0	5.0
Applied voltage maximum	Vdc	22	44	67	74	74	74	74	74
Electrical output		Minimum of 0.5% to 99.5% applied volts							
Resolution		Virtually infinite							
Hysteresis (repeatability)	mm	Less than 0.01							
Operational temperature	°C	-30 to +100							
Output smoothness		To MIL-R-39023 grade C 0.1%							
Insulation resistance		Greater than 100M Ω at 500V d.c.							
Operating mode		Voltage divider only - see Circuit Recommendation on page 2							
Wiper circuit impedance		Minimum of 100 x track resistance or 0.5M Ω (whichever is greater)							
Operating force maximum	gf	500 in horizontal plane							
Life at 250mm per second		Typically greater than 100 million operations (50×10^6 cycles) at 25mm stroke length							
Dither life		200 million operations (100×10^6 cycles) at ± 0.5 mm, 60Hz							
Shaft seal life		20 million operations (10×10^6 cycles) - replaceable							
Shaft velocity maximum	m/s	10							



OPTIONS

Connector Can be supplied with LEMO PHGOB304 CYMD42Z connector and sleeve GMAOB035DG

AVAILABILITY

Please consult our sales office for details

ORDERING CODES

D45190/...../.....

Electrical stroke _____
 A - no connector _____
 C - with connector _____

DIMENSIONS

All dimensions shown in mm

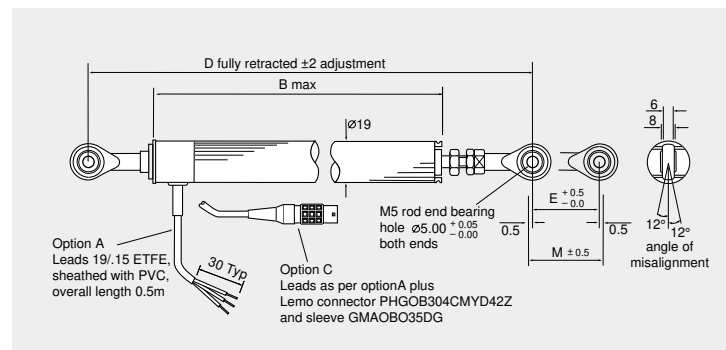

Note: Drawings not to scale

Electrical stroke E	mm	25	50	75	100	125	150	200	250
Mechanical stroke M	mm	29	54	79	104	129	154	204	254
Body length B	mm	107.0	132.0	157.0	207.0	232.0	257.0	307.0	357.0
Between centres D	mm	173.6	198.6	223.6	273.6	298.6	323.6	373.6	423.6
Weight approximate	gm	105	130	145	175	190	205	230	260

Available from Penny+Giles

A wide range of instrumentation for measurement and control solutions in industrial and aerospace applications. Please ask for more details.

Penny+Giles quality systems meet the requirements of ISO9001, the Civil Aviation Authority and numerous customer's certification standards.

Quality is at the heart of all our systems ensuring the reliability of our products from initial design to final despatch.



Registered No. 924881



- VRVTs ■ LVDTs - industrial/aerospace ■ Hybrid Linear Potentiometers
- Solenoids ■ Rotary Potentiometers ■ Joystick Controllers ■ In-Cylinder Transducers

Contact Worldwide

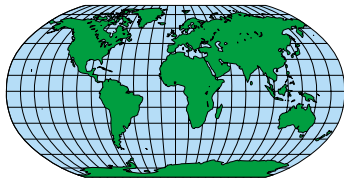

WEB SITE

www.pennyandgiles.com

UNITED KINGDOM

Penny+Giles Controls Ltd
 15 Airfield Road
 Christchurch
 Dorset BH23 3TJ
 Telephone: +44 (0) 1202 409409
 Fax: +44 (0) 1202 409410
 Email: xsales@pennyandgiles.com

USA

Penny+Giles Controls Inc
 12701 Schabarum Avenue
 Irwindale CA 91706
 Telephone: +1 626 337 0400
 Fax: +1 626 337 0469
 Email: us.sales@pennyandgiles.com

GERMANY

Penny+Giles GmbH
 Straussenlettenstr. 7b
 85053 Ingolstadt
 Telephone: +49 (0) 841 61000
 Fax: +49 (0) 841 61300
 Email: info@penny-giles.de

Penny+Giles products are in service with these industries throughout the world.

Aerospace
 Automotive
 Construction
 Defence
 Leisure
 Marine
 Material handling
 Mining

Motorsport
 Off-highway
 Petrochemical
 Plastics and Rubber
 Power generation
 Process control
 Transportation
 Timber and Forestry

The information contained in this brochure on product applications should be used by customers for guidance only. Penny & Giles Controls Ltd. makes no warranty or representation in respect of product fitness or suitability for any particular design application, environment, or otherwise, except as may subsequently be agreed in a contract for the sale and purchase of products. Customer's should therefore satisfy themselves of the actual performance requirements and subsequently the products suitability for any particular design application and the environment in which the product is to be used.

Continual research and development may require change to products and specification without prior notification. All trademarks acknowledged

© Penny+Giles Controls Ltd 2003

Penny+Giles
 A Curtiss-Wright Company